

Digital Force Gauges

FGV-H & FGE-H Series

Superior performance for capacities up to 500 pounds!

The microprocessor-controlled, digital FGV-H and FGE-H series offers the same user-friendly features of our popular FGV and FGE series, but in an extremely heavy-duty case, allowing the gauges to handle larger capacities from 0 to 500 pounds. Two “knurled” steel handles are provided for hand operation and a hanger is included which enables each gauge to be used as a scale.

The FGV-H series includes all FGE-H features plus RS232C and analog outputs and an overload output signal.



FGE-H with FGS-250VL high-capacity motorized test stand

Features

Benefits

Reversible display	Permits inverting the gauge for test stand or handheld operation without disassembly of case
Outstanding accuracy ($\pm 0.2\%$ F.S.)	Ideal for even the strictest tolerances
Peak measurement	Captured with the push of a button
Rechargeable batteries	Operates continuously for 20 hours when fully charged
Field calibration through keypad	Eliminates down time
Overload capacity: 200% F.S.	High capacity overload protection leads to fewer repairs
Overload output signal (FGV-H models)	Prevents load cell damage by automatically terminating test stand operation
RS232C and analog outputs (FGV-H models)	Allows flexibility in data collection and function analysis
Variable units of measure (lbs, kgs or N)	Easily selected with the touch of a button
Heavy-duty load sensor	Designed for over one million operations
Rugged die-cast aluminum housing	Production floor capable, able to withstand hostile work environments
Two heavy-duty “knurled” steel handles	Enable easy hand operation
Removable hanger	Enables gauge to be used as a scale
Measures both compression and tension forces	Conveniently determined with the same sensing shaft
Auto power shut-off	Prolongs battery life
Low battery indicator	Provides ample warning to complete testing (3 hours or more)
Ergonomically designed	Fits in the palm of your hand
One year warranty	Peace of mind

Digital Force Gauges

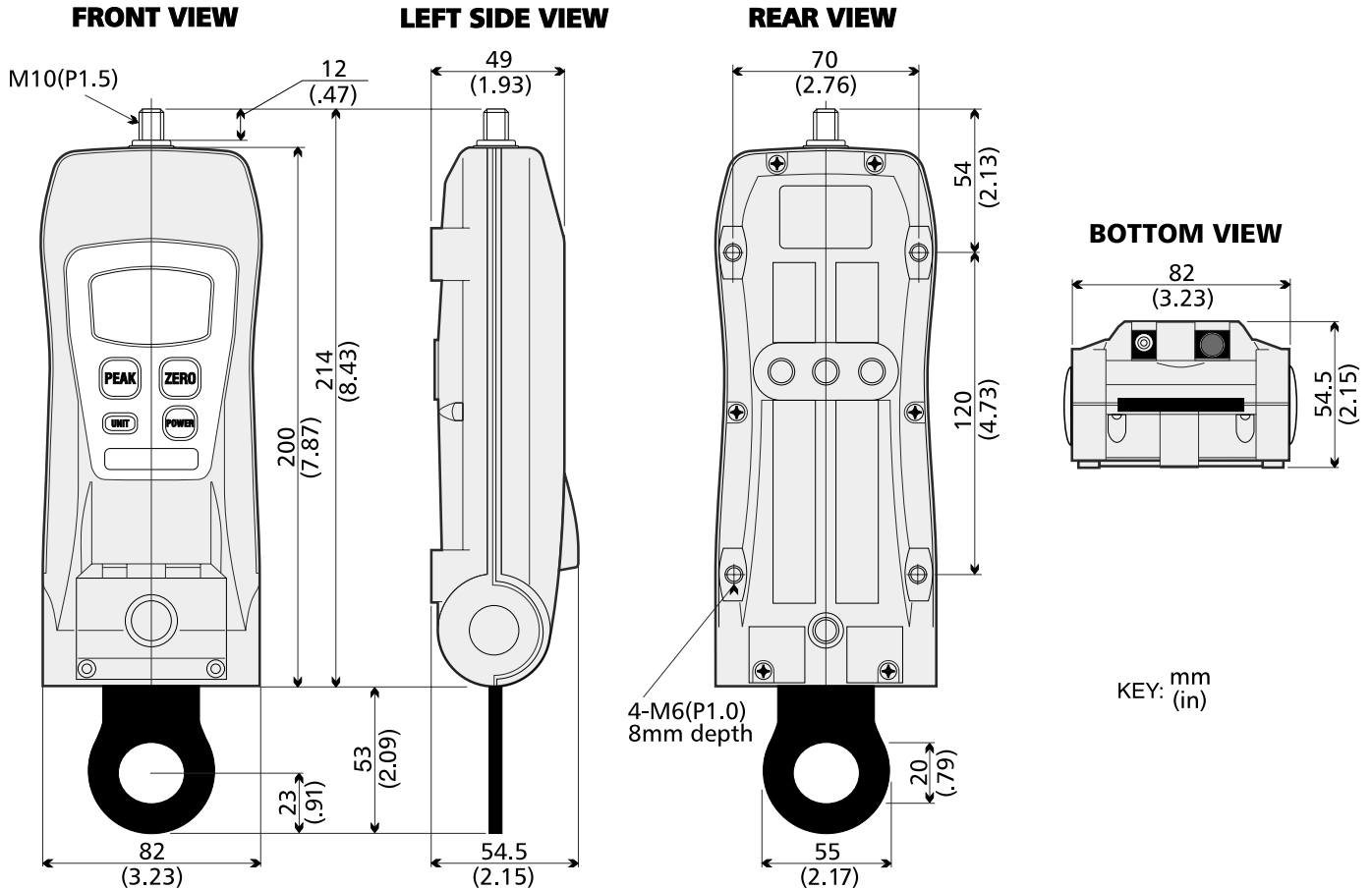

FGV - H & FGE - H SPECIFICATIONS						
Model	FGE-200H	FGE-300H	FGE-500H	FGV-200H	FGV-300H	FGV-500H
Capacity	200 lb 100 kg 1000 N	300 lb 150 kg 1500 N	500 lb 250 kg 2500 N	200 lb 100 kg 1000 N	300 lb 150 kg 1500 N	500 lb 250 kg 2500 N
Resolution	0.1 lb/0.1 kg/1 N					
Accuracy	±0.2% FS. + 1/2 digit at 73°F (23°C)					
Display	Four digit LCD, .47" high (12 mm) with various indicators including tension and low battery indication (reversible)					
Average/Peak Mode	Selectable					
Display Update	0.3 sec					
Sampling Rate	35/sec					
Overload Capacity	200% of FS.		150% of FS.	200% of FS.		150% of FS.
Power	Rechargeable Ni-Cad batteries (included) last approximately 20 hours in continuous operation when fully charged AC adapter/charger (included) for continuous use					
Auto Power Shut-Off	Yes (not active if adapter/charger is in use)					
Operating Temperature Range	32° - 104°F (0° - 40°C)					
Dimension / Weight	8.5" L x 3.4" W x 2.2" H (214 mm x 82 mm x 55 mm) / 2 lb (900 g)					
Standard Accessories	AC adapter/charger, carrying case, 2 handles and 6 attachments (flat head, hook, chisel, notched head, cone head, extension rod) The FGV-H also includes an analog output cable (See "FGV-H OUTPUT SPECIFICATIONS" chart below)					
OPTIONAL ACCESSORIES	Test stands and additional attachments RS232C cable is available for the FGV-H (See "FGV-H OUTPUT SPECIFICATIONS" chart below)					

FGV - H OUTPUT SPECIFICATIONS					
RS232C Output Port	Baud rate: 2400 bps	Data length: 8 bits	Stop bit: 1 bit	Parity: none	Software flow control: none
Analog Output Port	±1 VDC output (through a 12 bit D/A converter)				
Overload Output	One NPN OC transistor for tension, one NPN OC transistor for compression				